



Directional Control Valves for Hazardous and Corrosive Environments.

INSTALLATION, OPERATING & MAINTENANCE INSTRUCTIONS

VALVE TYPES: (A)S06-CPV
(A)S09-CPV
(A)S12-CPV
(A)S19-CPV
(A)S25-CPV
+CN1 to +CN8

DESCRIPTION: **1/4, 3/8 + 1/2" CYLINDER PLUG VALVES (CPV)**
MANIFOLD MOUNT `CN` TYPE FLOW CONTROL VALVES

Greenside Way, Middleton, Manchester M24 1SW United Kingdom

Tel: +44 (0) 161-345 4777 **Fax:** +44 (0) 161-345 4780

E-mail: sales@bifold-fluidpower.co.uk **www:** www.bifold-fluidpower.co.uk

Registered in England 1787729 Registered Office: Greenside Way, Middleton, Manchester M24 1SW

Filename OPB0045_00

Issue 0

Date 13/12/11

Page 1 of 3

1.0 INTRODUCTION

The following procedures apply to all in-line mounting, pneumatic or low pressure liquid service, cylinder plug type (CPV) flow control valves. Refer to the specific valve installation drawings for the operating parameters.

2.0 INSTALLATION

As the CPV is bidirectional, the valves can be mounted in any attitude. Check that the connecting tube fittings or valve have a compatible thread form. Standard valves have an NPT thread form; this taper thread requires the use of a thread sealant. NB It is not a dry-seal thread form.

Bifold Fluidpower strongly recommend that tube fittings are sealed into the fluid ports using thread sealant, Loctite 577 or equivalent, and that PTFE tape is not used (N/A to manifold mount type)

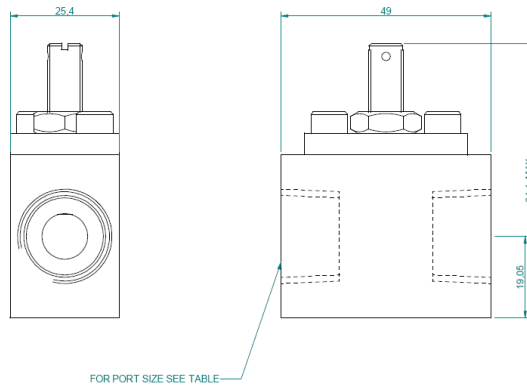

Fig a) Sizes up to 1/2"

VALVE TYPE	PORT SIZE
S06-CPV-01	1/4 NPT
S09-CPV-01	3/8 NPT
S12-CPV-01	1/2 NPT

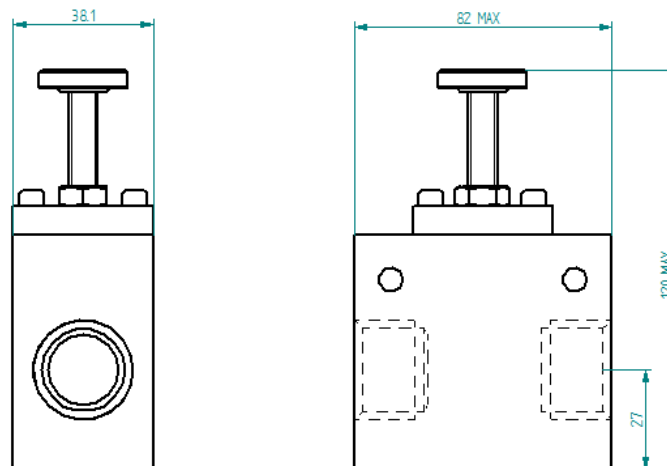

Fig b) Sizes up to 1"

3.0 **OPERATION**

Valves are supplied tested at 1.1 times the maximum working pressure marked on the valve body. Do not exceed this pressure during system proof pressure testing, or the stated working pressure under normal operating conditions.

NOTE The maximum permissible working pressure varies according to the valve model number.

The control element is a reciprocating cylinder with an integral elastomer O-ring. The sealing integrity of the valve element is exceptionally good provided high standards of fluid cleanliness are maintained. Bifold Fluidpower recommends that all tubing is thoroughly flushed or blown through prior to the valve being installed, and that for liquid service a fluid cleanliness level equal to or better than NAS 1638 Class 9 / ISO 4406 Class 18/15 is maintained.

4.0 **MAINTENANCE**

No annual maintenance is necessary on pneumatic or low pressure hydraulic service cylinder plug type flow control valves.